

Abdeckung

Alu-Vorderblende r=55 mm
270 Grad geschlossen

Führung

C-4 kt Profil 33x36(46) Aluminium

F11



F12



Fallrohr

Nutrohr 40x1.5 Aluminium

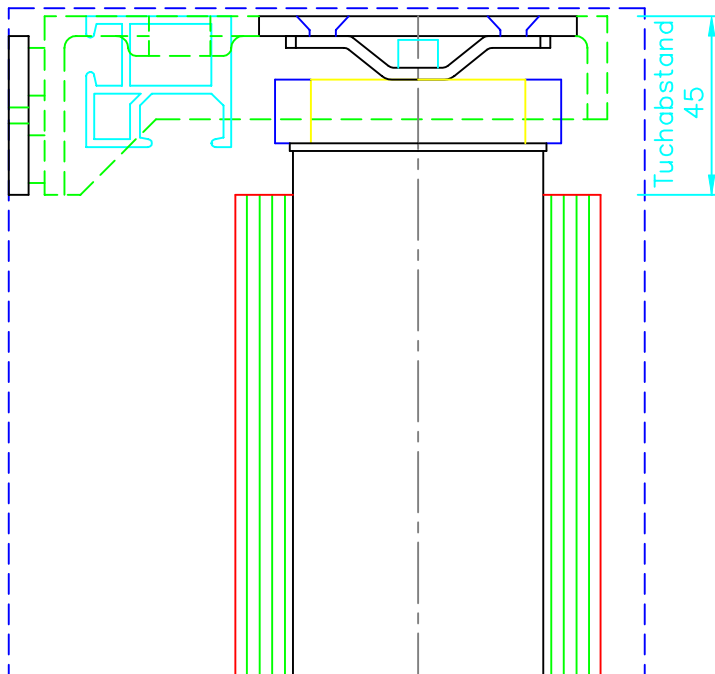
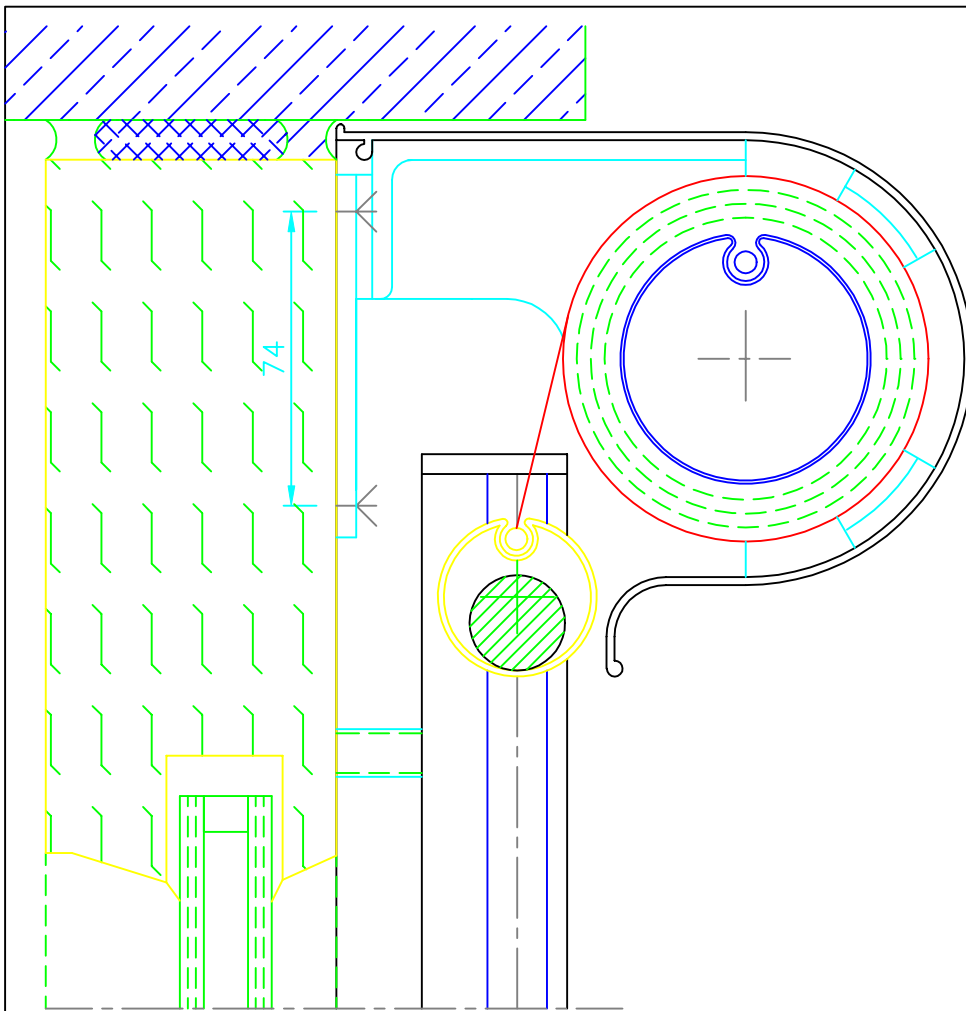

Tuchabstand
45

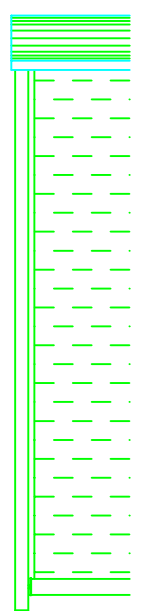
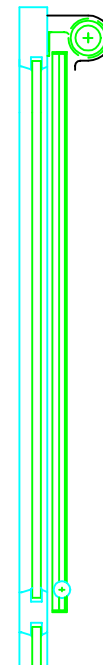

M 1:2

M 1:20



Markisen
Bautechnik GmbH

SENKRECHTMARKISE
Kurzbezeichnung: S1F11A17

71394 KERNEN Albert-Moser-Str. 87
Internet: <http://www.mbk-markisen.de>

max. Breite pro Feld : 3500 mm
maximale Höhe : 3000 mm
Zeichn. Nr. S1F11A17 23.11.2000 Wo

Telefon: 07151/450350
Fax : 07151/4503525